

DISCOVER SABI SAND NATURE RESERVE

&Beyond Kirkman's Kamp

Located high on a ridge, overlooking the magnificent Sand River, lies a lodge with a rich history and a safari experience like no other in the world.



DISCOVER THE SABI SAND NATURE RESERVE &Beyond Kirkman's Kamp

Why stay?

1 WORLD CLASS LOCATION

The Sabi Sand Nature Reserve is one of the most prestigious wildlife sanctuaries in the world, with unfenced borders neighbouring the Kruger National Park, and is famed for its leopards and incredible wildlife. The uniqueness of the lodge is its ideal positioning on the Sand River with exclusive access to the riverbed.

2 BIG FIVE WILDLIFE

In addition to incredible leopard viewing, and the famous Big Five, discover a vast variety of plant and animal species that share 2-million hectares of land with the Kruger National Park. Encounter a few of the over 500 bird species, 145 animal species, 110 reptile species and 45 fish species, that call this vast landscape home.

3 TRAVERSING RIGHTS

Kirkman's Kamp has exclusive traversing rights on 10 500 hectares (26 000 acres) of wilderness land, which means our guests can explore the reserve on-foot, free from the constraints of roads and vehicles, go on a night drive, or sensitively go off-road enabling closer wildlife interactions.

4 FAMILY FRIENDLY

Kirkman's Kamp welcomes families and offers an incredible, fun-filled WILDchild experience, including croquet and cricket on the lawns, a game of tennis and cookie baking. The variety of children's activities tie in with the particular environment, as well as the local heritage and culture of the region. The lodge's Family Cottage is ideal for safari-loving families.



It's the most magical place I have ever been (honestly)! We were totally blown away with the lodge and the destination.



&BEYOND GUEST

DISCOVER THE SABI SAND NATURE RESERVE

&Beyond Kirkman's Kamp

Lodge amenities

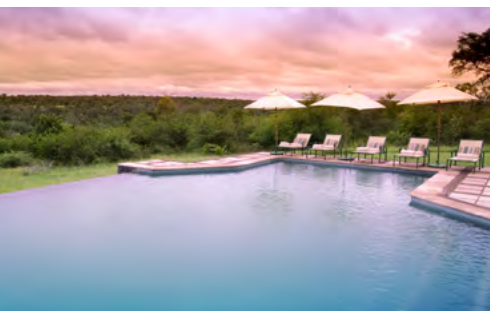

1

SWIMMING POOL

The sparkling rim flow swimming pool is incredibly inviting in the lowveld heat. Boasting fantastic views over the river, this is the perfect place not only to refresh, but to enjoy delectable meals and cocktails.



2

SAFARI SHOP

The Safari Shop boasts a range of quality, handpicked crafts and fashion wear showcasing the very best facets of the region, including stunning jewellery designed and fashioned by artisans from the local community, who draw on ethnic styles and motifs.



3

TENNIS COURT

Enjoy a friendly game of tennis played on the very court that was originally opened by legendary tennis player Billie Jean King.



4

SAFARI ACCESSORIES

A complimentary pair of SWAROVSKI OPTIK CL Companion 8x30 binoculars, for your use throughout your stay, as well as a take-home Guides' Journal featuring wildlife checklists and maps.



5

PAUL'S PUB

Named after the owner's father Paul, this bar is the central hub of the lodge. Each evening, guests meet here for drinks with their guide and fellow guests before dinner, recounting the sightings after a day's safari.

DISCOVER THE SABI SAND NATURE RESERVE

Beyond Kirkman's Kamp

Lodge amenities



6

BOMA

After your evening game drive, enjoy a pan-African al fresco dinner under the stars and around the open blazing fire in the lodge's traditional boma.



7

SPA WELLNESS TREATMENTS

Enjoy a relaxing wellness massage or treatment, using only 100% natural Healing Earth products, in the comfort and privacy of the lodge's exquisite massage room overlooking the riverbed below.



8

LIBRARY

The library offers a sanctuary filled with interesting reads, while the classical sitting room provides the perfect setting to enjoy a cup of tea and board game.



9

PERSONAL BARS

Your cottage boasts a private mini-bar and coffee station, to be enjoyed during the quiet moments in your room.



10

DINING LOCATIONS

Enjoy your meals in a variety of al fresco locations such as the outdoor boma area, the lush lawn overlooking the river, the swimming pool or the privacy of your room.

DISCOVER THE SABI SAND NATURE RESERVE
&Beyond Kirkman's Kamp Layout

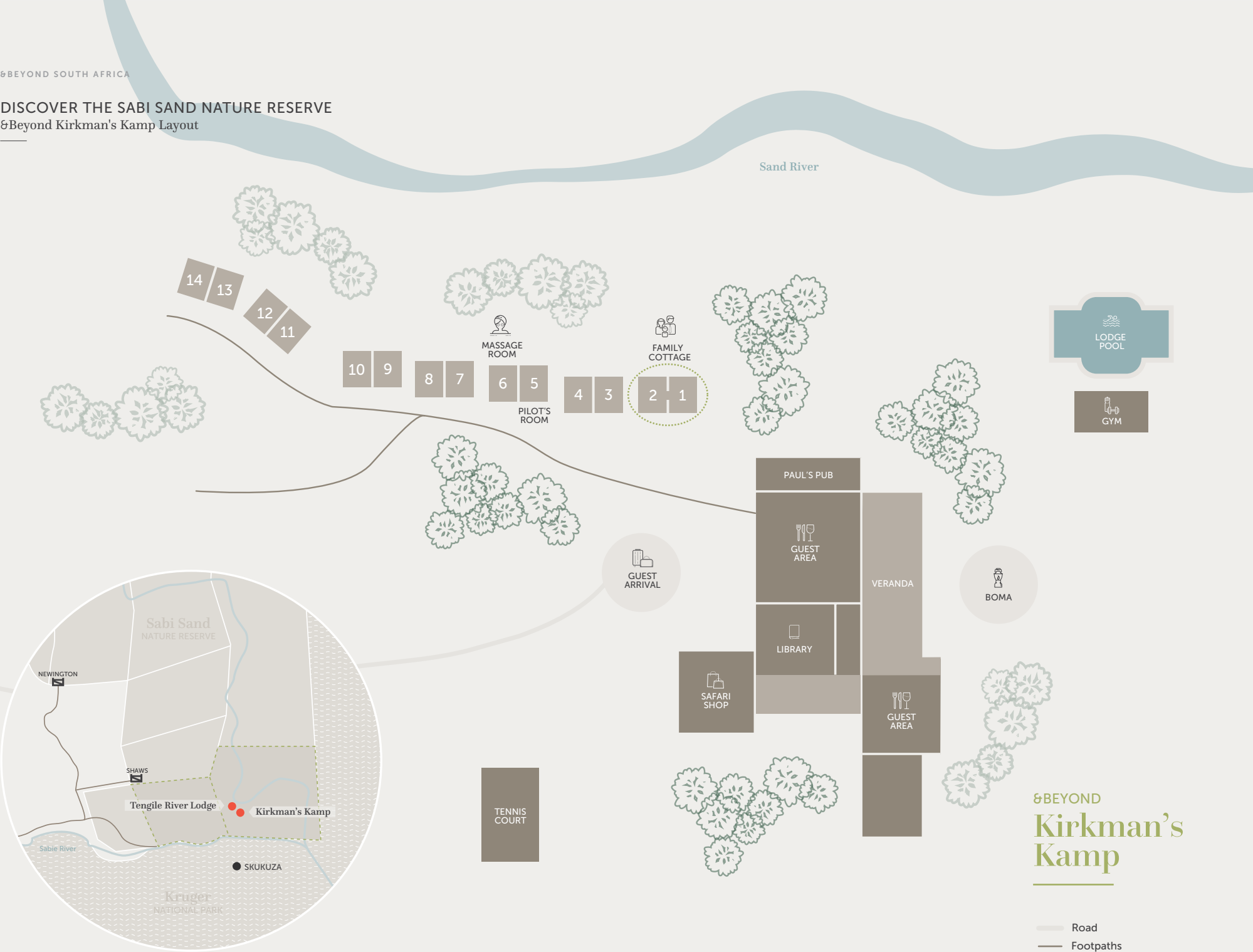

DISCOVER THE SABI SAND NATURE RESERVE

&Beyond Kirkman's Kamp

Lodge overview

LODGE

Maximum number of guests	25
Number of cottages	12
Cottage types	12 Cottages, including 1 Family Cottage
Family accommodation	Children of all ages are welcome 1 triple cottage (for children 16-years and younger only) 1 interconnected Family Cottage (max. 2 adults and 2 children)
WILDchild programme	Yes
Pilot / Guide accomodation	Yes
Distance between rooms	3 to 6 m (9.8 to 19.6 ft) between cottages Each cottage is adjoined to one other cottage
Check in / Check out times	14h00 / 11h00, with early check-in and late check-out on request
Lodge closure	Open year-round

DINING

Food / Dietary options	Kosher and Halaal available upon request and at an additional cost Please advise the lodge in advance with at least four weeks' notice
Private butler service	Yes
Plated service	Yes
Private dining	Yes

PAYMENT TYPES

Credit cards accepted	Visa, Diners, Amex and Mastercard
Currency	All major currencies accepted

FACILITIES

Power	220v AC (50 Hz) plug points in rooms
Internet access	Yes, Wi-Fi in suites and guest area
Wine store or cellar	Wine store
Boma	Yes
Bar	Yes
Interactive kitchen	No
Swimming pool	Yes, lodge swimming pool
Wellness offering	Spa overlooking the riverbed
Fitness centre	Yes
Conference facilities	No
Weddings & blessings	Yes
Wheelchair accessibility	Yes, with assistance, but not recommended
Complimentary laundry service	Yes
&Beyond Safari Shop	Yes

OTHER

Vehicle type	Nine-seater open safari vehicle Max 6-7 per vehicle
Private 4x4 safari vehicle	Yes, depending on availability and at an additional cost

DISCOVER THE SABI SAND NATURE RESERVE
&Beyond Kirkman's Kamp

Inclusions

RATE INCLUDES

Accommodation	✓
Three meals daily	✓
Soft drinks, house wines, local brand spirits and beers, teas and coffees and refreshments on game drives	✓
Laundry	✓
Safari activities	✓
One-hour nature walks accompanied by experienced armed trackers – subject to availability	✓
Emergency medical evacuation insurance	✓
VAT	✓
Transfers to-and-from Skukuza Airport	✓
One complimentary pair of SWAROVSKI OPTIK CL Companion 8x30 binoculars per cottage to share during your stay	✓

RATE EXCLUDES

Administration fee	×
Telephone calls	×
Safari Shop purchases	×
Gratuities	×
All items of a personal nature	×
Champagne, cognacs, fine wines, premium brand spirits and cigars	×
Government bed levy	×
Conservancy or park fees	×
Landing fees	×

NOTE: Unmanned Aerial Vehicles: Please be advised that the use of unmanned aerial vehicles (drones) are prohibited in the conservation areas we manage, until such time as their impact on wildlife and anti-poaching initiatives can be assessed. This rule will apply throughout Africa, as our partners in various countries and regions have adopted a similar stance.



DISCOVER THE SABI SAND NATURE RESERVE

&Beyond Kirkman's Kamp

WILDchild

&Beyond Kirkman's Kamp offers a range of fascinating and entertaining activities for children aged 3 – 12 years, bringing alive the magic of Africa. Whilst on a family safari, you can rest assured that your children will always be safe and well cared for (both on and off game drives). Every minute is supervised by our guides and lodge staff, who provide hours of amusement and invaluable information to the children in their care.

WHY WE LOVE &BEYOND'S FAMILY SAFARIS

- Special WILDchild programme for children aged 3 - 12 years
- Each WILDchild receives a backpack filled with age-appropriate goodies
- Activities are seasonal and include bark rubbing, bug collecting, frog safaris, 'poo walks', baking with the chef and more
- Special children's menus available

FAMILY ACCOMMODATION

Family Cottage	Children of all ages are welcome 1 interconnected Family Cottage (max. 2 adults and 2 children) 1 triple cottage (for children 16-years and younger only)
----------------	---

CHILD POLICY*

0 – 6 years	Not permitted on game drive
6 – 12 years	Permitted on game drives at ranger's discretion. Not permitted on walks outside of the lodge grounds
12 – 16 years	Permitted on game drives and nature walks Not permitted on Specialist Walking Safaris

**The child policy applies to children participating on game drives with a private vehicle only. Children that share a vehicle with other guests not in their party, may be subject to activities only at the lodge manager's discretion.*

Please note: The lodge is not fenced off and children are required to have an adult accompanying them at all times.

Childminders are available but must be booked on the day of arrival. An hourly rate per child is payable at the lodge.



The experiences of WILDchild were such fun and so informative. It's quite impossible to think of when the children last had such fun on vacation. ”

&BEYOND GUEST

DISCOVER THE SABI SAND NATURE RESERVE
Adventures of a Lifetime

A day in the life

OF A GUEST

From the moment you wake up, your &Beyond experience is tailored to your interests and needs. Your butler and guide will discuss the day with you, including times and experiences, to ensure your day is as extraordinary as the location you are visiting. Here’s what to expect on an average day on safari in the Sabi Sand Nature Reserve.

TIMING	EXPERIENCE
Early morning	Wake-up call from your butler, with a hot cup of tea or coffee
Early morning	Enjoy an early-morning health shot or warm drink, plus a treat, in the guest area before heading out on your morning safari game drive
Early morning to mid-morning	Morning safari game drive with coffee and tea stop and snacks
Mid-morning	Tuck into breakfast at the lodge
Midday to early afternoon	Go on a guided nature walk or local community visit
Early afternoon	Savour lunch at the lodge
Afternoon	Revel in a luxurious wellness treatment in the comfort of your room or the massage sala
Mid-afternoon	Indulge in afternoon High Tea at the lodge
Late afternoon	Afternoon safari game drive with sundowner stop and snacks
Early evening	Pre-dinner drinks and snacks in the lodge’s guest area, bar or around the firepit
Evening	Unwind after an eventful day with dinner at the lodge
Late evening	Discover the wilderness after dark on a night safari game drive

*Timings and guest experiences are guidelines only.
All experiences are subject to availability and weather dependent. Some experiences are at an additional cost.*





& BEYOND

DISCOVER & BEYOND KIRKMAN'S KAMP

Kirkman's cottages



DISCOVER THE SABI SAND NATURE RESERVE
&Beyond Kirkman's Kamp Accommodation

Old world charm

&Beyond Kirkman's Kamp boasts 12 intimate Cottages, including 1 Family Cottage, each with glorious Sand River views. Each luxurious and spacious cottage consists of one bedroom with an ensuite bathroom and private veranda.



CONTEMPORARY & STYLISH BEDROOM



OUTDOOR SEATING WITH A VIEW



1920s GLAM BATHROOM

DISCOVER THE SABI SAND NATURE RESERVE
&Beyond Kirkman's Kamp Accommodation

COTTAGE

12 Cottages / Max. 2 guests per Cottage



SPECTACULAR VIEWS
Kirkman's Kamp's 12 air-conditioned guest cottages are reminiscent of an old farmstead, and each faces the glorious Sand River where elephants and other wild animals roam free. The cosy rooms each have an ensuite bathroom with a shower, plus a private outdoor veranda boasting magnificent Sabi Sand views.

ROOM FACILITIES

Cottage sizes	Approx. 34 m ² (111.5 ft ²)
Private veranda	Yes
Private plunge pool	No
Personal bar	Yes
Personal coffee station	Yes
Air conditioning / heating	Yes
Overhead fans	Yes
Mosquito nets	No, sealed room
Bath	No
Shower	Yes, indoor shower only
Seperate WC	Yes
Telephone	Yes
Hairdryer	Yes
Internet access	Yes
In-room safe	Yes
Plug type	220V AC Plug Type C, D, M, N Adapters available
Triple bed option	Yes, for children 3 – 16 years, sharing with one or two adults Subject to availability
Twin bed option	Yes
Double bed option	Yes
Wheelchair accessibility	Yes, with assistance, but not recommended

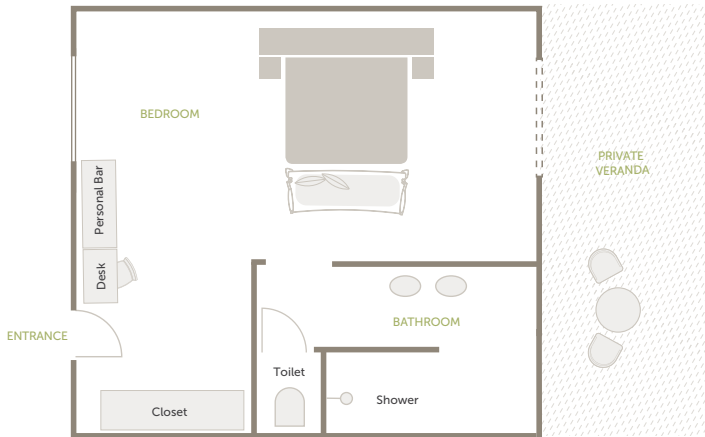

Typical Cottage layout

DISCOVER THE SABI SAND NATURE RESERVE
& Beyond Kirkman's Kamp Accommodation

FAMILY COTTAGE

1 interconnected Family Cottage / Max. 2 adults and 2 children



QUALITY FAMILY-TIME
Kirkman's Kamp has one Family Cottage, which is two regular cottages with an interleading doorway. The spacious Family Cottage has two bedrooms each with its own private ensuite bathroom and outdoor veranda. The interleading doorway between the two cottages provides families with the necessary privacy, but also allows for much-needed quality time.

ROOM FACILITIES

Cottage sizes	Approx. 34 m ² (111.5 ft ²) each – two cottages
Cottage configuration	Two cottages with an interleading doorway
Private veranda	Yes
Private plunge pool	No
Personal bar	Yes
Personal coffee station	Yes
Air conditioning / heating	Yes
Overhead fans	Yes
Mosquito nets	No, sealed room
Bath	No
Shower	Yes, indoor shower only
Seperate WC	Yes
Telephone	Yes
Hairdryer	Yes
Internet access	Yes
In-room safe	Yes
Plug type	220V AC Plug Type C, D, M, N Adapters available
Wheelchair accessibility	Yes, with assistance, but not recommended

Maximum two adults and two children (three children on request – third child must be 3 – 16 years old)

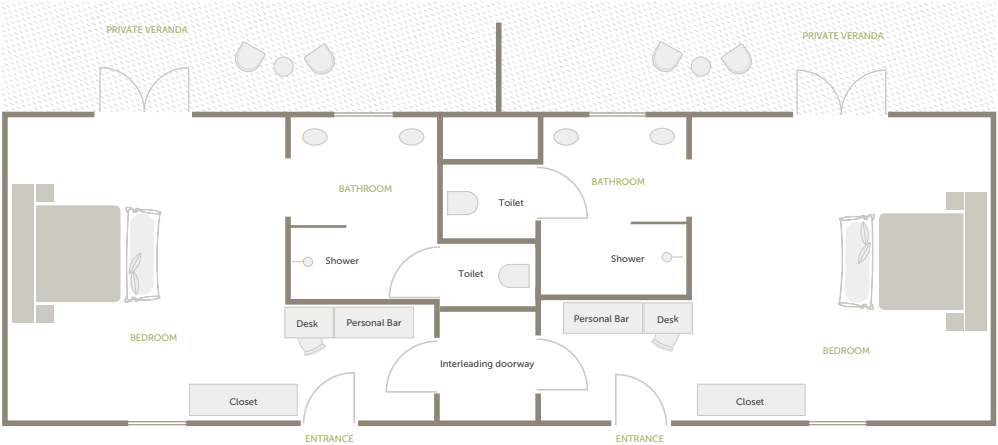

Family Cottage layout



DISCOVER THE SABI SAND NATURE RESERVE

Adventures of a lifetime

Encounter iconic wildlife on an &Beyond
African safari, and enjoy an array of private
and specialist experiences.



DISCOVER THE SABI SAND NATURE RESERVE
Adventures of a Lifetime

Experiences and highlights

In between your twice-daily game drives, why not take a nature walk with your guide, or indulge in a luxurious wellness treatment.



1

SAFARI GAME DRIVES

Enjoy twice-daily game drives that set off early in the morning or late in the afternoon (continuing after nightfall) in the company of expert safari guides and local trackers who will do their best to ensure that all your wishes are met. In addition to the Big Five (lion, leopard, rhino, elephant and buffalo), each safari features an iconic set of wildlife and an opportunity to encounter the famous Sabi Sand leopard.



2

NATURE WALKS

Experience a range of natural wonders in the company of your experienced professional guide on a nature walk. Learn how to track, seeing how close you can come to smaller game, such as impala and zebra, without them being aware of your presence. Each bush walk is accompanied by an expertly-trained and qualified guide, who follows strict protocols to ensure your safety and comfort.



3

LOCAL COMMUNITY VISITS

A community visit provides a first-hand experience of the projects Wild Impact*, our long-standing community and conservation development partner, is facilitating and supporting to enable future leaders, healthy ecosystems, future foundations and thriving communities. Visit projects in the Huntingdon and Justicia communities, such as the Happy Homes Preschool or nearby Madilika Craft Centre.

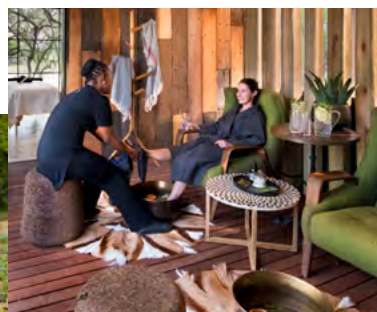

4

WELLNESS TREATMENTS**

After a safari-filled day indulge in the pleasures of a Healing Earth wellness treatment either in-room or in your lodge's tranquil spa or massage sala. &Beyond has partnered with Healing Earth, a leading natural, holistic spa and skincare company, to produce a truly authentic African spa experience for the mind, body and soul.



5

WEDDINGS**

From a classic safari wedding in the open bush to a sunset ceremony overlooking a spectacular view or a walk down the aisle in the dry bed of an African river, our meticulous wedding planners can put together a celebration filled with breathtaking moments and joyful surprises that will pamper and delight any couple.

*Formerly Africa Foundation

**These experiences and highlights are at an additional cost and subject to availability.

DISCOVER THE SABI SAND NATURE RESERVE
Adventures of a Lifetime

Specialist safaris and trips

When booking a private vehicle and specialist guide, our safaris can be tailor-made to suit a wide range of interests.



1

SHANGAAN VILLAGE TOUR

Visit a Shangaan community, situated just outside Sabi Sand Nature Reserve, and interact with the friendly people of Mpumalanga. A Bantu tribal group, the Shangaan are the dominant group in the northeast of South Africa. A local guide will escort you through the village, sharing interesting insights and narratives about Shangaan culture, including its fascinating customs, beliefs and traditions.



2

PRIVATE GAME DRIVES

A private safari game drive allows you to explore the concession at your own pace while focusing on your special interests. With your own dedicated ranger and tracker team, in your own private 4x4 safari vehicle, &Beyond's exclusive private safaris let you create your very own tailor-made wildlife adventure.



3

FAMILY SAFARIS

The Sabi Sand Nature Reserve welcomes all ages, and is the ideal reserve for nature-loving families wishing to spend some much-needed quality time in the African bush. Tailor your safari experience to suit the whole family. Both &Beyond Kirkman's Kamp and Tengile River Lodge also feature a spacious Family Cottage and Family Suite respectively.



4

BIRDING SAFARIS

Birding safaris are just one of &Beyond's many unrivalled specialist safaris that can be personalised for any small group. Accompanied by one of &Beyond's specialist birding guides, set out in search of over 300 bird species that inhabit the Sabi Sand, notable ones including the bateleur, black-bellied bustard and comb duck.



5

WALKING SAFARIS

Dependant on the availability of a specialist guide, your ranger and tracker will tailor your walking experience to suit your personal requirements and preferences. Whether it be to follow a specific animal, unravelling the details of its daily life, or to spend the whole day exploring, a walking safari offers the opportunity to experience Africa at its wildest and most personal.

DISCOVER THE SABI SAND NATURE RESERVE

Adventures of a Lifetime

Year-round activities

- ✓ Big Five game viewing
- ✓ Private game drives*
- ✓ Night drives*
- ✓ Nature walks*
- ✓ Specialist walking safaris*
- ✓ Specialist family safaris*
- ✓ Specialist birding safaris*
- ✓ Local community visits
- ✓ Shangaan village tour
- ✓ Boma dinners*
- ✓ Bush-dining*
- ✓ Sundowners*
- ✓ Wellness treatments
- ✓ Safari Shop
- ✓ Weddings

**Subject to availability of a private vehicle, specialist guide or tracker, or are weather dependent*



In terms of game viewing - dreams came true and we got stunning sightings of all the Big Five and mostly importantly the elusive leopard. ”

DISCOVER THE SABI SAND NATURE RESERVE
Adventures of a Lifetime

Timing is everything

	JAN	FEB	MAR	APR	MAY	JUN	JUL	AUG	SEP	OCT	NOV	DEC
Tracking or walking safaris: Winter – cooler walking conditions during the day					✓	✓	✓	✓	✓			
Photography: Summer – landscapes are lush and green with full watering holes and lots of animals	✓	✓	✓						✓	✓	✓	✓
Night drives: Summer – although offered year-round, the summer months are best as evenings are warmer	✓	✓	✓	✓					✓	✓	✓	✓
Baby animals: Summer – typically at the start of the rainy season	✓	✓									✓	✓
Game viewing: Winter to early spring – animals are known to gather around waterholes and are easier to spot in the thinned-out bush					✓	✓	✓	✓	✓	✓		
Birding: Year-round – however, if you'd like to see lots of birds then summer is best when the migrant birds return	✓	✓	✓							✓	✓	✓



DISCOVER THE SABI SAND NATURE RESERVE

Sustainability initiatives

In partnership with Wild Impact*, our long-standing community and conservation development partner.



CARE OF Land

- 53 362 Plastic water bottles eliminated per year by ♻️Beyond Mpumalanga** lodges as a result of on-site bottling plants
- 40 000 Litres, daily average reuse of wastewater by our Sabi Sand lodges
- 100% of our ♻️Beyond Mpumalanga lodges have advanced wastewater treatment plants
- 5.4 Kg CO₂ per head reduction annually in our Mpumalanga region since 2018
- 98% Achieved by ♻️Beyond Ngala Private Game Reserve in an environmental audit conducted by the specialist Rhengu Environmental Services
- 18% improvement in ♻️Beyond Mpumalanga sustainability audit scores since 2016, highlighting a progressive reduction of our direct carbon footprint through a system of ♻️Beyond Group goals



CARE OF Wildlife

- 64 Learners and teachers received conservation lessons in 2019, with the aim not only to educate, but also develop an understanding of the interdependence of conservation and community empowerment
- 25 200 Hectares of rich biodiversity significantly influenced by ♻️Beyond Ngala Private Game Reserve (14 700 Ha) and Sabi Sand Game Reserve (10 500 Ha)
- 414 000 ZAR contributed in annual park fees, July 2019 – March 2020
- 984 Leopard sightings documented by ♻️Beyond Sabi Sand guides in 2018 in collaboration with Panthera's regional leopard research programme



CARE OF People

- 29 Years of compounded positive impact, across 23 local communities
- 50 Million ZAR annual disbursements to Mpumalanga communities, 2018 - 2020
- 55 % Local community staff to total employees at our ♻️Beyond Mpumalanga lodges
- 272 CLEF tertiary education bursaries granted to 206 young Mpumalanga leaders through this legacy-building Wild Impact programme
- 28 Million ZAR local-procurement spend by ♻️Beyond Mpumalanga, 2018 - 2020
- 17 Million ZAR social infrastructure investment in collaborative, community-led projects
- 3.2 Million ZAR donor funding for Bilton High School, Thlvekisa, close to ♻️Beyond Ngala Private Game Reserve, in a community project spanning 7 years

DISCOVER THE SABI SAND NATURE RESERVE

Travel South Africa and beyond

South Africa has an excellent travel network that makes it easy to reach any destination, by air or road.



GETTING TO THE SABI SAND

Airlink offers daily scheduled flights from Johannesburg to Skukuza airport, which is followed by an easy 20-minute drive to the lodges.

Connect Sabi Sand Nature Reserve to Johannesburg, Cape Town, &Beyond Ngala Private Game Reserve, or the northern Sabi Sand Nature Reserve (Londolozi and Ulusaba). All flights route through either Nelspruit or Skukuza, where layovers vary.

Private charters from anywhere in South Africa can be arranged to the Sabi Sand Nature Reserve.

It is five-hour drive from Johannesburg on good roads in a two-wheel drive vehicle.

TRAVEL TIMES

JOHANNESBURG

	5hrs 18mins (466.3 km) 2hrs 10mins (45mins layover)*	KRUGER NATIONAL PARK - NGALA PRIVATE GAME RESERVE			
	5hrs 22mins (452.1 km) 50mins*	2hrs 4mins (89.4 km) 45mins*	SABI SAND - SOUTH (SKUKUZA AIRPORT) - KIRKMAN'S AND TENGILE		
	6hrs 11mins (488.1 km) 2hrs 15mins*	1hr 18mins (46.8 km) 45mins*	1hr 51mins (80 km) Not available	SABI SAND - NORTH	
	6hrs 35mins (533.8 km) 3hrs 25mins (1hr 25mins layover)*	8hrs 48mins (657 km) 2hrs 10mins (20mins layover)*	7hrs 34mins (590 km) 3hrs 20mins (50mins layover)*	8hrs 40mins (636 km) 4hrs 45mins*	PHINDA
	14hrs 14mins (1 397.8 km) 2hrs 10mins*	19hrs 59mins (1 907 km) 3hrs 35mins*	19hrs 33mins (1 849 km) 4hrs*	20hrs 53mins (1 890 km) 4hrs*	20hrs 31mins (1 830 km) 4hrs 35mins (45mins layover)*
					CAPE TOWN

*Airlink flights may include layovers ranging from 20-minutes to 2-hours depending on routing. Return flight times may differ for this reason.

&BEYOND LODGES

- KRUGER NATIONAL PARK**
Ngala Safari Lodge
Ngala Tented Camp
- SABI SAND NATURE RESERVE**
Kirkman's Kamp
Tengile River Lodge
- PHINDA PRIVATE GAME RESERVE**
Phinda Mountain Lodge
Phinda Forest Lodge
Phinda Rock Lodge
Phinda Vlei Lodge
Phinda Zuka Lodge
Phinda Homestead



andBEYOND



@andbeyondtravel
#seewhatliesbeyond

andBeyond.com

GENERAL ENQUIRIES
+27 11 809 4300
contactus@andBeyond.com

REGIONAL ENQUIRIES
africa.reservations@andBeyond.com
southasia.reservations@andBeyond.com
southamerica.reservations@andBeyond.com

PRESS ENQUIRIES
media@andBeyond.com

TRAVEL TRADE
enquiry@andBeyond.com